



# THE MESSENGER

NEWS & HAPPENINGS IN NEW CUMBERLAND BOROUGH



**IN THIS ISSUE:**

Fall Clean Up

Why Our Trees are Disappearing

Back-to-School Safety

Fire Prevention Week

Fall Events

**AND MORE!**



**Leahys**  
**AUTO REPAIR & TOWING**

"LEAHYS SAVED THE DAY"  
 - DON L.  
 ★★★★★

"THE STAFF IS FRIENDLY AND HONEST."  
 - ROBYN M.  
 ★★★★★

"EXTREMELY PROFESSIONAL."  
 - DIERDRE H.  
 ★★★★★

"OUTSTANDING CUSTOMER SERVICE"  
 - ALEX O.  
 ★★★★★

"THE QUALITY SPEAKS FOR ITSELF"  
 - CACHITA W.  
 ★★★★★

PROUDLY LOCATED @  
**121 8TH ST. NEW CUMBERLAND**  
 LEAHYSAUTO.COM | 717.731.9648

.....2023.....  
**HOMELAND HOSPICE**  
**5K**  
*and Memory Walk*

**JOIN US! SATURDAY SEPT. 30**  
 ROSSMOYNE BUSINESS CENTER  
 MECHANICSBURG | 8:30 AM



Register at:  
[HomelandEvents.org/5K-MemoryWalk](http://HomelandEvents.org/5K-MemoryWalk)  
 Questions: 717-221-7890

**HOMELAND**  
*at Home*  
 HOSPICE

**Award-Winning Dog Grooming**

**TEG's**  
 Canine Clippery



**717-774-7262 • TEGS.us**

**A RELIABLE TECHNOLOGY PARTNER**  
 Could be the missing piece to your business success.



(717) 774-2018  
[SelectTech.us](http://SelectTech.us)

**SELECTECH** INC

**SHOPPING FOR A REALTOR?**

*Call Cathie!*

**Cathie Heika**  
 Associate Broker & Realtor®



- ✓ Pay Lower Commission, Receive Full Service!
- ✓ Sell Your Home **AS IS** With Minimal Showings!
- ✓ Receive Multiple, Competitive Offers!
- ✓ FREE Buyer and Seller Consultations!

Cell/Text: 717.554.9655  
 Office: 717.775.7000  
[CathieHeika@gmail.com](mailto:CathieHeika@gmail.com)

 **TURN KEY REALTY GROUP**

**www.CathieHeika.com**

**Rippin' Rides**  
 Keep 'em Rollin'  
 1537 Bridge St. New Cumberland, PA 17073  
 717.770.1177 [Sales@RippinRides.com](mailto:Sales@RippinRides.com)

1537 Bridge Street  
 NEW CUMBERLAND  
[www.RippinRides.com](http://www.RippinRides.com)



**FREE A/C Check**

**FULL SERVICE STATION**

- PA State Inspections
- Oil Changes
- Welding & Fabrication
- Fleet Service
- Brake Service & Repair
- A/C Service
- Classic Auto Care
- Vehicle Diagnostics
- Exhaust Repair
- Steering & Suspension

**Call today for an appointment 717-770-1177**

## BOROUGH CALENDAR

### SEPTEMBER

September 4 ..... Borough Office Closed  
 September 13 ..... Borough Council Meeting  
 September 14 ..... Food Truck & Restaurant Rally  
 September 15 ..... Music & Film Festival  
 September 16 ..... Music & Film Festival  
 September 17 ..... Music & Film Festival  
 September 19 ..... Library Board Meeting  
 September 20 ..... Planning Commission Meeting  
 September 30 ..... 27th Annual Apple Festival

### OCTOBER

October 7 ..... OCD Pennsylvania Walk  
 October 10 ..... Library Board Meeting  
 October 11 ..... Borough Council Meeting  
 October 12 ..... Food Truck & Restaurant Rally  
 October 13 ..... Halloween Parade (pending approval)  
 October 14 ..... 21st Annual Vickie's Angel Walk  
 October 18 ..... Planning Commission Meeting  
 October 21 ..... Yard Waste Collection  
 October 26 ..... Household Hazardous Waste  
 October 26 ..... Trick-or-Treat

### NOVEMBER

November 7 ..... Municipal Election Day  
 November 8 ..... Borough Council Meeting  
 November 9 ..... Food Truck & Restaurant Rally  
 November 15 ..... Planning Commission Meeting  
 November 17 ..... Accents on Bridge Gala  
 November 21 ..... Library Board Meeting  
 November 23 ..... SMT Turkey Trot  
 November 23,24 .... Borough Office Closed

### DECEMBER

December 2 ..... Christmas Market

For more details and events, visit  
[newcumberlandborough.com](http://newcumberlandborough.com)

## STAY CONNECTED

### Subscribe to the Monthly eMessenger

Visit [newcumberlandborough.com](http://newcumberlandborough.com), select the "Sign up for eNews" yellow button under the "Living Here" menu to sign up to receive monthly Borough newsletters to your email. You will continue to get the printed quarterly Messenger.

### Sign Up to Receive Emergency Alerts

Our community notification system gives residents, businesses, and visitors 24/7 access to important emergency alerts. CodeRED is built on the Onsolve communication system to ensure efficient, secure messaging via phone, email, and text. Please register online at [newcumberlandborough.com](http://newcumberlandborough.com), select the "Sign up for E-Alerts" green button under the "Living Here" menu or text newcumberlandpa to 99411 for a link to be sent to your phone.

### Sign Up to Receive CRIMEWATCH Alerts

Receive alerts through email or a mobile app about crime and arrests in New Cumberland Borough. The app lets you browse nearby crime and anonymously submit tips to authorities. Please register online at [newcumberlandborough.com](http://newcumberlandborough.com), select "Sign up for CRIMEWATCH Alerts" under the Departments/Police menu.



## FROM THE MAYOR...

Hello Everyone,

Wow, can you believe Summer is over and now we look to the fall and winter season. I personally love the months of September thru December. The cooler temperatures, fall foliage, football and all my favorite holidays. This fall will be a busy one as usual and I am working hard on providing opportunities that bring residents together and provide resources to those in need. Many great events are planned this fall with the annual Apple Festival, 1st ever New Cumberland Music and Film Festival, our annual Halloween Parade, Vickie's Angel Walk, SMT Turkey Trot, Christmas Market, and a whole lot more. If I can tell you one thing it's get involved, show up and volunteer. We need everyone working together to make all these things super successful. Remember as well that I am here to serve everyone as best I can. If you know someone or you yourself needs something, please reach out to me. I will respond and do whatever I can to help. Have a wonderful fall season and when you see me say hello, I'd love to meet you.

**Thaddeus Eisenhower**

Mayor of New Cumberland Borough

## IN THIS ISSUE

- General Information and Directory ..... 4
- New Resident Information ..... 5
- Fall Cleanup ..... 6,7
- Community Development & Codes ..... 7,8
  - New Lights At Riverside Park
  - Trees, Where Are They Going & Why?
  - Curb Cutout
- Police, Fire & EMS ..... 9
  - Back-To-School Safety Tips
  - Escape Planning
- Recreation ..... 10
  - Fall - Tastic Fun With WSREC
- Events In The Borough ..... 11,12
  - 37th Apple Festival
  - New Cumberland Music + Film Festival
  - OCD Pennsylvania Walk
  - 21st Annual Vickie's Angel Walk
  - Accents On Bridge – A New Cumberland Gala
  - SMT Turkey Trot
  - Christmas Market
  - Food Truck & Restaurant Rally

## PLANNING FOR THE 2024 BUDGET

One of the most important tasks New Cumberland Borough staff undertakes each year is development and management of the annual budget. In August and September, staff prepares a draft of the coming year's budget. In October and November, Borough Council conducts budget workshops. These meetings are always advertised on the website and are open to the public to attend in person. During these meetings Borough Council reviews and provides input on the proposed budgets for each of our funds, which includes General, Capital Improvements, and Liquid Fuels. At the conclusion of these meetings a Borough Council reviewed draft is introduced to the public and put on display in November with the goal of adoption at the December Borough Council Meeting.

# GENERAL INFORMATION & DIRECTORY

## NEW CUMBERLAND BOROUGH OFFICE

1120 Market St, New Cumberland, PA 17070  
Hours: Monday – Friday 8:30 a.m. – 4:30 p.m.  
Email: [info@newcumberlandborough.com](mailto:info@newcumberlandborough.com)  
Phone: (717) 774-0404  
Website: [newcumberlandborough.com](http://newcumberlandborough.com)

## BOROUGH DIRECTORY

Unless indicated otherwise, the phone number for the following contacts is (717) 774-0404.

Borough Manager, Nathaniel Dysard  
Building Code Official, Approved Codes, (717) 506-0464  
Chief of Police, Michael McLaughlin, (717) 774-0400  
Codes & Zoning, Brian Searle  
Community & Economic Development, Valerie Carchidi  
EMS, Deputy Chief, Edward Erlsten, (717) 774-0193  
Fire Chief, Jeff Gouldy, (717) 774-0193  
Library Director, Alana Bubnis, (717) 774-7820  
Public Works, Mark Hinton, (717) 774-7827

## BOROUGH COUNCIL – Four-year term

Robert P. Kline, President (2025)  
Donald W. Kibler, Vice-President (2023)  
DJ Landis (2025)  
Gennifer R. Richie (2025)  
David H. Stone (2023)  
Fred Miles (2025)  
Chad Wilson (2023)

## OTHER IMPORTANT NUMBERS

**Emergency** ..... 911  
Ambulance (non-emergency)..... (717) 774-0193  
Cumberland County Courthouse ..... (888) 697-0371  
District Justice..... (717) 737-3434  
Fire Department (non-emergency) ..... (717) 774-0193  
New Cumberland Library..... (717) 774-7820  
New Cumberland Post Office ..... (717) 774-7092  
Police Office (non-emergency) ..... (717) 774-0400  
Senior Citizens Center..... (717) 774-0409  
State Representative Sheryl Delozier ..... (717) 761-4665  
State Senator Mike Regan ..... (717) 432-1730  
Tax Collector ..... (717) 774-7424  
PA American Water ..... (800) 565-7292  
Penn Waste ..... (717) 767-4456  
PPL/Street Light Problems..... (800) 342-5775

## SCHOOLS

Cedar Cliff High School ..... (717) 737-8654  
Red Land High School..... (717) 938-6561  
Trinity High School ..... (717) 761-1116  
New Cumberland Middle School ..... (717) 774-0162  
Hillside Elementary ..... (717) 774-1321  
St. Theresa School ..... (717) 774-7464

## MAYOR

Thaddeus Eisenhower (2023)

## CONSTABLE – Six-year term

Thomas H. Dauchaux, First Ward (2027)  
Scott Cassidy, Second Ward, Second Ward (2027)

## DISTRICT JUSTICE – Six-year term

Christopher Delozier (2025)

## LIBRARY BOARD

Linda A. Ries, President (2024)  
Barbara C. Warfel, Vice-President (2023)  
George L. Labecki, Treasurer (2025)  
Joan Erney (2025)  
Kevin Hall (2025)  
Judith Hawthorn (2024)  
Gennifer R. Richie, Liaison (2023)

## POLICE CIVIL SERVICE COMMISSION

Gerald Ahnell, Chairman (2026)  
Lana Forconi, Secretary (2027)  
David Keller (2023)

## PROFESSIONAL SERVICES

Solicitor, Johnson Duffie – Michael J. Cassidy, Esq.  
Borough Engineer, Dawood Engineering, Inc  
Auditor, Hamilton & Musser, P.C.  
Insurance Broker of Record, Kocman Insurance Group (KIG)  
Pensions, Life & Disability Insurance, R. J. Hall, Inc.

## TAX COLLECTOR – Four-year term

Robin Gasperetti (2025)

## VACANCY BOARD

Jeanette Louise Magaro, Chairperson (2023)  
Borough Council

## ZONING HEARING BOARD – Three-year term

Maria D'Agostino, Chairperson (2023)  
Rebecca L. Parthemore (2025)  
John M. Repetz (2024)  
Michael J. Pykosh, Solicitor

## PLANNING COMMISSION – Four-year term

Faith T. Curran, Chairperson (2023)  
Fred Miles, Vice-Chairperson (2024)  
Norman J. Kennard, Secretary (2025)  
Ira Beckerman (2024)  
George Estep (2026)  
Jennifer McElrath (2023)  
Adam Trone (2025)  
Steve Hoffman, Consultant – Cumberland County Planning Commission



# NEW RESIDENT INFORMATION

Welcome to your new home in New Cumberland Borough! We hope the information provided below helps you.

## Dog License

Cumberland County requires that all dogs, three months or older, be licensed by January 1 of each year. Annual dog licenses range from \$4.50-\$8.50 and lifetime dog licenses range from \$21.50-\$51.50. Annual licenses can be purchased at New Cumberland Borough at 1120 Market St, New Cumberland or online at [doglicenses.us/PA/Cumberland](https://doglicenses.us/PA/Cumberland). Lifetime Licenses must be submitted by mail or in person at the Cumberland County Treasurer's Office, 1 Courthouse Square, Room 201, Carlisle. Lifetime Licenses cannot be purchased online or at the Borough. Find more details on [newcumberlandborough.com/license-your-dog-its-the-law/](https://newcumberlandborough.com/license-your-dog-its-the-law/).

## Driver's License & Motor Vehicle Registration

Out of state driver's licenses must be converted within 60 days of establishing residency. New residents must apply for a title and registration for their vehicle within 20 days. Annual vehicle registration and inspection are required in PA. For more information, visit [dmv.pa.gov](https://dmv.pa.gov).

## Gas & Electric

In Pennsylvania, you may choose the company that provides your natural gas and electricity. Supplier lists may be found at [pagasswitch.com](https://pagasswitch.com) and [papowerswitch.com](https://papowerswitch.com). Distribution of services and new connections are conducted by the individual utility. Within the Borough electric is distributed through [pplectric.com](https://pplectric.com) and gas is distributed by [ugi.com](https://ugi.com).

## Library Card

A card is free to New Cumberland Borough Residents. You can get a library card by visiting the New Cumberland Public Library at 1 Benjamin Plaza, New Cumberland, PA 17070 and completing a library card registration form. You can also request a digital library card online at [cumberlandcountylibraries.org/Get\\_Card2](https://cumberlandcountylibraries.org/Get_Card2).

## Mailing Address Change

File a change of address online, [moversguide.usps.com](https://moversguide.usps.com) or at the Post Office, 318 Bridge St, New Cumberland, PA 17070.

## Phone, Cable & Internet

Residents can choose between [verizon.com](https://verizon.com) or [xfinity.com](https://xfinity.com).

## Public Safety

The Borough is fortunate to have a dedicated Fire and EMS Department [newcumberlandfire.org](https://newcumberlandfire.org), Police Department [cumberland.crimewatchpa.com/newcumberlandpd](https://cumberland.crimewatchpa.com/newcumberlandpd), and River Rescue [ncrr100.com](https://ncrr100.com) that provide around-the-clock emergency services to protect our community. If you have an emergency, please dial 911.

## Public Transportation

rabbittransit offers regular weekday bus service. Find routes at [newcumberlandborough.com/hop-aboard-rabbittransit](https://newcumberlandborough.com/hop-aboard-rabbittransit).

## Public School Enrollment

New Cumberland Borough is in the West Shore School District, 507 Fishing Creek Road, New Cumberland, PA 17070. Call (717) 938-9577 or visit [wssd.k12.pa.us](https://wssd.k12.pa.us) for more information.

## Sewer & Water

The Borough's water and sewer is supplied through Pennsylvania American Water. New service can be established at [amwater.com](https://amwater.com).

## Sign Up for Emergency and CRIMEWATCH Alerts and Borough News

Find out how on page 3 of this publication.

## Street Light Outages

Streetlights are installed and maintained by PPL. Please call PPL directly to report broken lights or electrical outages at 1-800-DIAL-PPL (1-800-342-5775). Be prepared to provide a street address where the light is located. It is also helpful to provide the poll number, which is posted on each streetlight. To report green light outages for the decorative lights in downtown New Cumberland, please call the Borough at (717) 774-0404.

## Trash & Recycling

Trash and recycling services are provided by Penn Waste. Please contact New Cumberland Borough directly to establish or cancel service with Penn Waste and for any issue regarding your bill at (717) 774-0404. Find more information for trash and recycling [newcumberlandborough.com/living-here/trash-recycling/trash/](https://newcumberlandborough.com/living-here/trash-recycling/trash/).

## Voter Registration

To vote, you must be registered with the Cumberland County Bureau of Elections: [ccpa.net/1902/Voter-Registration](https://ccpa.net/1902/Voter-Registration). Find your poll location at [newcumberlandborough.com/poll-locations/](https://newcumberlandborough.com/poll-locations/).

# FALL CLEANUP

## LEAF COLLECTION

**Leaf collection begins the third week of October.**

- All leaves are to be raked into the street at the curb line.
- The schedule will repeat each week beginning with the first area.
- In the event of inclement weather or equipment problems, the schedule will resume where interrupted.
- The street sweeper will work in conjunction with the leaf collection equipment by sweeping the center of each street ahead of the leaf collector and then by sweeping behind it along the curb.
- Please DO NOT place any large objects with the leaves such as branches, sticks, bricks, stones, etc., that could damage the leaf collection equipment.
- The collection schedule for each area will end on the designated day during the first full week of December. This may change due to early winter weather events.
- There will be no alley pick-ups.
- Please refrain from parking close to leaf piles. Our equipment has difficulty reaching the curb line when vehicles are parked too close to leaf piles.

## YARD WASTE COLLECTION

**What:** Yard waste is material such as tree trimmings, shrubbery, and other organic landscape vegetation. It does NOT include grass clippings, fruits and vegetables, tree stumps, dirt, and stones. These non-yard waste items can be disposed of with your normal trash collection if it is in a container. For grass clippings, it's suggested you practice grass-cycling and leave them on your lawn. The benefits are great for your lawn, saves you time and keeps them out of the landfill.

**How:** Place yard waste in biodegradable brown paper bags or bundle it with biodegradable twine in easy-to handle bundles. Bundles may be no longer than five feet in length; not exceed six inches in diameter; and not weigh more than 30 pounds each. An unlimited number of brown paper bags or bundles may be placed at the curb. Do not put yard waste in plastic bags. It will not be collected.

**When:** Pick up is October 21, 2023. Once prepared, yard waste must be placed at the curb before 6 a.m. Do not put yard waste out during your regular collection day.

### DO NOT PLACE THESE ITEMS OUT FOR YARD WASTE COLLECTION

Grass Clipping



Fruits & Vegetables



Tree Stumps



Dirt & Stones



## LARGE ITEM DISPOSAL

One large household item per week will be collected from a residence by Penn Waste, Inc. on any regular collection day. This service is only available to residential customers included in the Borough's trash collection and recycling contract. You must call Penn Waste to arrange your large item pickup at (717) 767-4456 or (866) 575-8720 at least 48 hours prior to your regular collection day.

### Acceptable items:

- |   |  |
|---|--|
| • Appliances such as Refrigerators and Washing Machines | • Car Tires (tires only and must be removed from rims) |
| • Carpet (48" max length, rolled and tied)              | • Scrap Metal (48" max length)                         |
| • Furniture   | • Mattresses & Box Springs                             |

### The following items will NOT be collected:

- |   |  |
|---|--|
| • Electronics – You can recycle electronics at Cumberland County's Electronics Recycling Center, which is located at 1001 Claremont Road in Carlisle. | • Construction Material or Debris: drywall, brick, block, treated lumber, roofing shingles, ceiling tiles and concrete |
| • Paints, stains, chemicals, and liquids  | • Batteries  |
| • Automobile parts  | • Household Hazardous Waste  |
| • Tires on rims   | • Commercial and Industrial Waste  |
| • No loose piles. All small items must be boxed.  | • No items which are too heavy to be lifted into a truck by two people.  |

(continued on next page)

## FALL CLEANUP *continued*

### HOUSEHOLD HAZARDOUS WASTE DISPOSAL



Household Hazardous Waste (HHW) consists of products in the home which are corrosive (drain cleaners or bleach), flammable (gasoline or kerosene), reactive (chemistry kits and photographic chemicals) or toxic (pesticides and insecticides). Penn Waste is NOT authorized to pick up these materials. These materials may NOT be placed in your curbside trash.

Cumberland County offers a HHW collection recycling program to give the residents of Cumberland County an alternative disposal method for these types of wastes. There is one more event in 2023: Thursday, October 26.

Appointments are required and a fee of \$0.55/lb will be charged. For more details and to sign up, go to <https://www.cumberlandcountypa.gov/3499/2023-HHW-Disposal-Program>.

## COMMUNITY DEVELOPMENT & CODES

### NEW LIGHTS AT RIVERSIDE PARK

**Location:** 101 3rd Ave, New Cumberland, PA 17070

In the summer of 2021, New Cumberland Borough entered into a lease with Norfolk Southern for the river access area at the end of 3rd Avenue. The Borough is committed to improving the recreational and safety attributes of this site for the benefit of the community. In July, new lights were installed at Riverside Park to increase safety and prevent unwanted and unruly conduct. Please remember all Borough Parks close at dusk.

**Uses:** Fish from the banks or launch your boat at the boat ramp. No jet skis. Be careful of river rocks that may cause damage to boats.

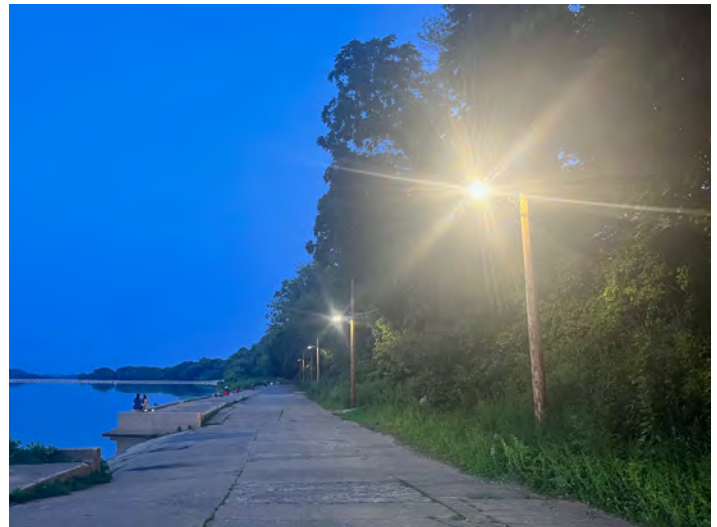

(continued on next page)



### 21 Years A Beacon of Hope

We take away toxic financial  
stress, allowing healing.

**“Old Town Angels”**  
help our New Cumberland neighbors battling cancer  
**Donate \$25**

100% of your donation stays in New Cumberland  
helping local families in desperate need of  
your financial support.



**vickie's angel**  
FOUNDATION

A FINANCIAL BRIDGE FOR FAMILIES FIGHTING CANCER

**717-774-3800 • [VickiesAngelFoundation.org](https://VickiesAngelFoundation.org)**

## TREES, WHERE ARE THEY GOING & WHY?

No matter the route, when you enter the Borough of New Cumberland, a noticeable canopy of trees is appreciated. However, age, disease, and strong storms to name a few, are taking a toll on our shade trees. What can you do to maintain and increase our shade trees canopy? Plant a tree – the right tree in the right spot is the key to decades of shade, songbirds, energy savings and beauty. Recommendations for the variety of trees to plant can be secured from a reputable arborist or a community forester from the PA Department of Conservation and Natural Resources.

Why are trees disappearing in the Borough and across the region? This article is the first in a quarterly series looking at factors that contribute to the loss of trees and our tree canopy.

Stressful conditions can reduce a tree's ability to produce energy as well as force the tree to divert energy from growth, flowering, and fruiting to defense. Reducing energy production results in less storage of energy (starch in woody plants) and can exhaust a trees' defenses. Some stressful conditions are acute and may not last very long like a seasonal drought, while others are more chronic such as compacted soil conditions. It is often when trees are under stress from abiotic (non-living) causes and energy and defenses become limited that biotic stressors like insect pests and disease pathogens are more easily able to establish, exacerbating tree decline and death.

The struggles trees face when growing in many urban or suburban settings can mean the difference between healthy trees that provide shade, boosts property values, and improves air quality or expensive removals. When we think about tree stressors, we often think about insects and diseases that can certainly impact trees, but there are numerous abiotic (non-living) stressors that cause the demise of thousands of urban trees. Those abiotic tree stressors can be grouped into several categories such as environmental factors, site factors, and human activities. The first topic in this quarterly series is environmental stressors.

### Environmental Stressors

The first environmental stress that comes to most minds is drought. Water stress may be caused by a lack of rain, or it may be caused by inadequate soil space from which to draw water. Drought is a primary contributing factor to tree decline. environmental stressors like insufficient water are often the primary cause. Even with adequate soil space and precipitation, drought stress can occur from root injuries that short-circuit the tree's ability to take up water and nutrients that may be available.

Another environmental stress can be a late spring frost or freeze that damage newly emerging leaves. Water expands as it freezes in plant tissues, bursting cell walls. When the tissue thaws again, the ruptured cells die and darken soon after. Tender tissues are prone to such injury in late spring frosts. If leaves are damaged in the spring, the tree will need to dip into reserve (or stored) energy to create new leaves needed for photosynthesis that growing season.

Extreme heat can be a major stress on some species of trees, causing moisture loss, leaf scorch, and premature leaf drop. In many cases, heat stress includes a component of drought stress, as the tree moves more water via evapotranspiration to combat the effects of heat, often exceeding the available water in the ground. This stressor can be exacerbated by site conditions found in parking lots or downtown streetscapes with limited soil space and lots of reflected heat.

Snow and ice loading during the winter can cause major limb breakage, which results in a reduction in a tree's canopy. That lost leafy canopy reduces the trees ability to produce energy for itself, leading to stress on the tree. Ice can increase the weight of a branch by 30 times or greater, depending on the thickness of the ice, making it more susceptible to breakage. This content was adapted from a Penn State Extension article.



## CURB CUTOUT

SECOND STREET – GEARY AVENUE (4 Ramps)	SECOND STREET – WOODLAND AVENUE (2 Ramps)
SECOND STREET – ROSEMONT AVENUE (1 Ramp)	SECOND STREET – EUTAW AVENUE (4 Ramps)
POPLAR AVENUE – FOURTH STREET (2 Ramps)	SIXTH STREET – BRANDT AVENUE (2 Ramps)

Construction will be completed by October 2023. A big thank you to the Cumberland County Housing and Redevelopment Authority for a \$100,000 Community Development Block Grant (CDBG) that helped make this project happen.



# POLICE, FIRE & EMS

## BACK-TO-SCHOOL SAFETY TIPS

It is hard to believe that summer is over and the kids are back at school. The New Cumberland Police Department would like you to keep these safety tips in mind when travelling in New Cumberland Borough.

1. Watch your speed in school zones! Be aware that school zone speed limits may vary in hours of operation but are always 15 MPH.
2. New Cumberland Borough is a walkable town. Slowdown in residential areas. Watch for children crossing the street and congregating near bus stops.
3. Do not pass a school bus that stops to load or unload children. Traffic in both directions on all Borough roadways must stop when students are entering or exiting a school bus (the red flashing lights and extended stop sign arms are your cues to stop).
4. Be alert! The area ten (10) feet around a school bus is where children are in the most danger of being struck. Children walking to and from their bus are usually very comfortable with their surroundings and more likely to take risks, ignore hazards, or fail to look both ways when crossing a street.
5. Watch for bikes. Children on bicycles are unpredictable.
6. Always stop when directed to do so by a school patrol sign, a Police Officer, or a designated crossing guard.
7. If you are dropping off or picking up children from school use the designated drop off/pick-up zone. Follow the rules established by the school when completing this task.

## ESCAPE PLANNING

**October 8-14, 2023 is Fire Prevention Week. Plan Ahead!** If a fire breaks out in your home you may have only a few minutes to get out safely once the smoke alarm sounds. Everyone needs to know what to do and where to go if there is a fire.

- » **MAKE** a home escape plan. Draw a map of your home showing all doors and windows. Discuss the plan with everyone in your home.
- » **KNOW** at least two ways out of every room, if possible. Make sure all doors and windows leading outside open easily.
- » **HAVE** an outside meeting place (like a tree, light pole or mailbox) a safe distance from the home where everyone should meet.
- » **PRACTICE** your home fire drill at night and during the day with everyone in your home, twice a year.
- » **PRACTICE** using different ways out.
- » **TEACH** children how to escape on their own in case you can't help them.
- » **CLOSE** doors behind you as you leave.

### IF THE ALARM SOUNDS...

- » If the smoke alarm sounds, **GET OUT AND STAY OUT**. Never go back inside for people or pets.
- » If you have to escape through smoke, **GET LOW AND GO** under the smoke to your way out.
- » **CALL** the fire department from outside your home.

**Thank you to New Cumberland Borough's Fire, EMS and Police that help keep our community safe!**

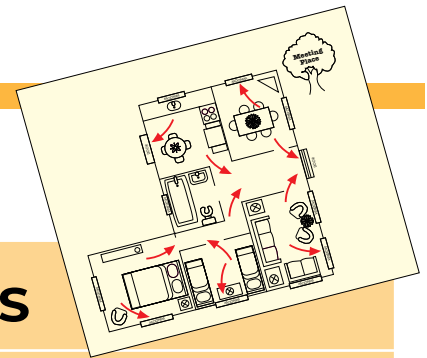

## FACTS

- ! A closed door may slow the spread of smoke, heat, and fire. Install smoke alarms inside every sleeping room and outside each separate sleeping area. Install alarms on every level of the home. Smoke alarms should be interconnected. When one smoke alarm sounds, they all sound.
- ! According to an NFPA survey, only one of every three American households have actually developed and practiced a home fire escape plan.
- ! While **71%** of Americans have an escape plan in case of a fire, only **47%** of those have practiced it.
- ! **One-third** of American households who made an estimate thought they would have at least 6 minutes before a fire in their home would become life-threatening. The time available is often less. And only **8%** said their first thought on hearing a smoke alarm would be to get out!



Your Source for **SAFETY** Information

NFPA Public Education Division • 1 Batterymarch Park, Quincy, MA 02169  
[www.nfpa.org/education](http://www.nfpa.org/education)

# RECREATION

## **"FALL – TASTIC FUN WITH WSREC!"**

**HEALTHY ACTIVITIES FOR YOU!** – Don't wait to get in better shape! Start now with Aquatic Workouts, Pickleball, PiYo, SalsaTone, Yoga, Pilates, and many more!

**GET YOUR KIDS ACTIVE WITH THE ALWAYS POPULAR...** Kinderdance, Kinder Tots, Kinder Gym, Art, Horsemanship, Tennis, and Swimming Lessons.

**S.T.E.A.M. AFTERSCHOOL PROGRAMS ARE BACK** Ignite Your Child's Imagination, and Curiosity while having FUN! STEAM Clubs are offered at several elementary schools starting in September. Covering the topics of Robotics, Engineering and Coding.

**GET READY FOR THE SEASON** – Take a trip; Stourbridge Train Ride, Eastern State Penitentiary and Ghost Tour, Scenic Trains of WVA, Christmas at Old Sturbridge Village, Longwood Gardens and NYC on Your Own. Limited Spaces, Make your reservations early.

Following are a few highlights of the programs we offer. For a complete list of dates, times, locations, and cost of upcoming programs visit us at [www.wsrec.org](http://www.wsrec.org) or call (717) 920-9515.



### **West Shore Senior Center - New Cumberland**

#### **PAINTING WORKSHOPS**

No painting experience necessary and all supplies are included. Students will learn to use acrylic paint to create deep shadows and bold highlights in their paintings, as well as paint brush usage and techniques to create desired effect.

#### **BELLY DANCE – Level 2**

For intermediate level students with belly dance experience. Work on different styles of choreography including Folkloric, Traditional, Classical, and Fusion. Instructor: June Minaya.

#### **BODY TONING**

Body Toning is an overall workout designed to target major and minor muscle groups. This workout is a creative and fun way to work on muscular endurance and strength training.

#### **KINDER TOTS**

Designed especially for 2 year olds. Includes movement, music, fitness and fun! Blending of color, numbers, and shape learning right into the class. Child must be 2 years of age prior to class. Parental assistance may be needed. Instructor: Kinderdance.

#### **KINDER GYM**

Boys and girls 3-5 years will be introduced to tumbling and the pre-apparatus skills of gymnastics. Emphasis is on coordination and exercise. Instructor: Kinderdance.

#### **MEDICARE 101 EDUCATIONAL SEMINAR**

If you're seeking information for yourself or helping a family member navigate Medicare's complexities, we are here to help.

#### **KINDERDANCE**

Start your preschooler off on the right foot. The focus is on coordination, movement, and exercise to music for 3-5 year old children. This class includes an introduction to ballet, tap, and acrobatics. Instructor: Kinderdance.

#### **TAI CHI**

Tai Chi is a martial art that can be practiced by practically anyone. Tai Chi's slow, precise movements promote relaxation and better health while improving strength, focus, and balance.

### **Fairview Fire Station – New Cumberland**

#### **INTRO TO PHOTOGRAPHY**

Each class will explore a new topic followed by some hands-on application of the technique. Learn the history of photography and cameras, the science behind a DSLR, about photography influences, lenses exposure triangle - aperture, shutter speed and ISO, composition techniques, and much, much more.

**Cardio Step, Hatha Flow Yoga, Muscle Pump, Pilates – All Levels SalsaTone Zumba Step, Zumba Toning, and Babysitting Certification.**

### **Hillside Elementary School – After School**

#### **YOUTH ART FUN**

Join local artist and instructor Allison Juliana for a fun and creative program this fall! All supplies are included. Grades 3-5.

# EVENTS IN THE BOROUGH

## 37th APPLE FESTIVAL

NEW CUMBERLAND

APPLE  
FESTIVAL

**September 30, 2023 9 a.m. to 4 p.m.** Don't miss apples, entertainment, crafters, activities for kids, food vendors, and fun for the entire family at the 37th New Cumberland Apple Festival. Entertainers will keep you humming and tapping your foot while you are sitting on a bale of straw enjoying the best sandwich and sweet stuff you can find. Come rain or shine. The Apple Festival is provided to the community by the New Cumberland Olde Towne Association and sponsored by Giant Food Stores, Karns Foods and the Kiwanis of West Shore. Be sure to enter the Apple Pie Contest and the Lego Contest for gift card prizes. Find applications at [applefestivalnewcumberlandpa.com](http://applefestivalnewcumberlandpa.com). Want to get involved? Contact Chris Leukus at (717) 319-4421 or [cvleukus@aol.com](mailto:cvleukus@aol.com).

## NEW CUMBERLAND MUSIC + FILM FESTIVAL

**Saturday, September 15-17, 2023** A weekend of music-related films, live musical performances, and a celebration of New Cumberland Borough's burgeoning arts community. Designed to showcase the town's past and emerging cultural scene, the intimate festival will feature a diverse lineup of local bands mixed with music-themed films from around the country. Many events will take place at the West Shore Theatre, with additional events happening around New Cumberland, from a music video showcase to street performances by area musicians. Find details at <https://www.newcumberland.co/>.



## OCD PENNSYLVANIA WALK

**Saturday, October 7, 2023** Obsessive Compulsive Disorder (OCD) and related disorders affect more than 1 in 100 people around the world — but there is hope. As treatment providers, people with lived OCD experience, and family members, we are working together to provide support, raise awareness, reduce the stigma of talking about mental health and to raise funds for the International OCD Foundation and its local affiliates, enabling them to continue their mission.

The OCD Walk in New Cumberland Borough Park is about building a community of support and making sure people know how to access the resources and support they need.

## 21st ANNUAL VICKIE'S ANGEL WALK

**Saturday, October 14, 2023** The 21st Annual Vickie's Angel Walk raises funds for Vickie's Angel Foundation to support their mission to help individuals in Central Pennsylvania going through active cancer treatment who cannot pay their bills because of their cancer. Sign up at <https://www.vickiesangelfoundation.org/>



(continued on next page)

Nobody knows or appreciates **New Cumberland** like those of us who live here! Your **neighbor and Realtor** for more than 2 decades.

**JULIE  
GILBERTSON**  
REALTOR®



**Cell: (717) 979-2769**

E-Mail: [remax1st@icloud.com](mailto:remax1st@icloud.com)



Each Office Independently Owned and Operated

### ANNOUNCING!!

**Now licensed in Florida as well!**

Serving the northeast coast areas of St. Augustine, Ponte Vedra, & Jacksonville.

Your snowbird or relocation expert- lending advice about the tax increases, insurance concerns, HOA and CDD fees!

*Fellow agents- count on me for your referral fee!*



**RE/MAX®**  
1st ADVANTAGE

6375 Mercury Drive, Suite 101 • Mechanicsburg, PA 17050 • Office: (717) 591-5555



## ACCENTS ON BRIDGE – A NEW CUMBERLAND GALA

**Friday, November 17, 2023 – 6-10 p.m.** Hosted by the New Cumberland Olde Towne Association and Business & Professional Group, together with the Borough of New Cumberland, Accents on Bridge is a fundraising gala that will support the purchase of benches, planters, and trash receptacles to enhance our Borough. Attendees will enjoy hearty hors d'oeuvres, a served dinner, drinks, a live band, dancing, silent auction, and more. Our goal is to raise \$40,000. To purchase tickets online visit <https://newcumberlandpa.org/accents>. Location: Susquehanna Club – 608 Ross Avenue, New Cumberland, PA 17070.



## SMT TURKEY TROT



**Thursday, November 23, 2023** Join other trotters at the New Cumberland Borough Park for the 19th Annual SMT 5K Turkey Trot that raises funds for Vickie's Angel Foundation to support their mission to help individuals in Central Pennsylvania going through active cancer treatment who cannot pay their bills because of their cancer. Sign up at: <https://runsignup.com/Race/PA/NewCumberland/SMTTurkeyTrot>

## CHRISTMAS MARKET

**Saturday, December 2, 2023** Start your holiday season off at the 2nd annual New Cumberland Christmas Market, the perfect place to gather with family and friends, and to feel some Christmas spirit. Join us on Market Square in downtown New Cumberland Borough from 3 p.m. to 7 p.m. to experience a taste of an authentic German Christmas Market. Enjoy live music and food, and shop for handcrafted holiday decor and gifts.



## FOOD TRUCK & RESTAURANT RALLY



Community members are invited to attend the New Cumberland Food Truck & Restaurant Rally, which started Thursday, March 9, 2023, and continues successive second Thursdays through December, from 5 to 8 p.m. at Market Square on Market Street in New Cumberland. Tempt your taste buds with fresh, savory fare from numerous area food trucks. Find more information on <https://newcumberlandpa.org/events/>.

# SECURE CREMATIONS

at a

# PRICE YOU CAN AFFORD

*Call today for more information.*



CENTRAL PENNSYLVANIA  
Cremation Society, Inc.

3125 Walnut St. • Harrisburg, PA 17109

**(717) 671-1289**

**CentralPaCremation.com**

*Peter J. Stegman, Supervisor*

# Your child deserves the best.



The region's only children's hospital. Nationally ranked for excellent care, 13 years running.



**PennState Health**  
Children's Hospital

**NOAH, AGE 3**  
Bainbridge, Pa.  
Pediatric cancer patient

## IMPORTANT REMINDER

There are more home fires in winter than in any other season. Half of all home heating fires happen in December, January and February.

As you stay cozy and warm this winter season, be fire smart!



**NATIONAL FIRE  
PROTECTION ASSOCIATION**

The leading information and knowledge resource  
on fire, electrical and related hazards

[nfpa.org/education](http://nfpa.org/education)

## Family Is What Matters Most

Helping families in their time of need is the bedrock of our Family Tradition Of Caring. We are proud to have been taking care of families, like yours, for three generations. We dedicate ourselves to helping make things better, when things are at their worst. Talk with us today about how we can help your family.



**717-774-7721**

*Gilbert J. Parthemore, Supervisor*

**[www.Parthemore.com](http://www.Parthemore.com)**

1303 Bridge Street, New Cumberland



Auto | Home | Commercial | Contractors | Bonds | Liability | Life

**(717) 774-8128**

704 Bridge Street • New Cumberland, PA 17070

Call us today for free quotes!

**Your hometown HVAC team!**

# DAFLURE®

**HEATING • COOLING • SOLAR**

please call or text us anytime, 24/7, at

**717-774-9480**

or visit us at

**[www.Daflure.com](http://www.Daflure.com)**

CONNECT WITH US ON





## Life is Good at the Woods!



*Award-Winning Independent Living,  
Personal Care and Memory Care*

717.737.3373 • [TheWoodsAtCedarRun.com](http://TheWoodsAtCedarRun.com)



## Mt. Olivet Cemetery

A not-for-profit association managed by local professionals and directed by a board of volunteers who all grew up in New Cumberland and have relatives at Mt. Olivet.

**Website:**

[mtolivetcemetery.org](http://mtolivetcemetery.org)

**Email:**

[info@mtolivetcemetery.org](mailto:info@mtolivetcemetery.org)

**Phone:**

717-774-2150

New Cumberland's Cemetery

*WE STRIVE TO BE THE MOST  
FAMILY-FRIENDLY, AFFORDABLE,  
AND BEAUTIFUL CEMETERY  
ON THE WEST SHORE.*

### ANNUAL FAMILY & FRIENDS MEETING SEPTEMBER 29, 2023

5:30 TO 7PM AT MT. OLIVET CEMETERY



*Sam Brinley with Families & Friends Last Year*

All current and prospective families and friends are invited to our Third Annual Family & Friends Meeting on Friday September 29th from 5:30 to 7pm. It's a wonderful opportunity to get to better know one another, hear about the latest improvements and initiatives, and discuss ideas for the future. No reservations are required, but for planning purposes we'd appreciate your RSVP, see our website for more information [www.mtolivetcemetery.org](http://www.mtolivetcemetery.org).

Hope you can join us,

Sam Brinley, General Manager

Volunteer Board: Nancy and Denny Derr, Deb Shenck, Gene Brinton, Robert Nauss Whitmoyer, Andy and Marty Kohr



This publication is produced at no cost to New Cumberland Borough residents thanks to the generous sponsorship of the businesses listed throughout the newsletter. The Township recognized these businesses as community supporters and encourages residents to also suggest these local businesses with their patronage.

Our Mission Is To Quench The Thirst  
Of Our Beer Community With Continually  
Evolving Fresh Ideas And A Constant Drive  
For The Highest Quality Product.



**EVER GRAIN  
BREWING CO.**

4444 Carlisle Pike Suite C  
Camp Hill, PA 17011  
1 (717) 525-8222  
[evergrainbrewing.com](http://evergrainbrewing.com)



523 Bridge Street  
New Cumberland, PA 17070  
717.774.2536

[www.aheavenlytouchspa.com](http://www.aheavenlytouchspa.com)

Electrolysis • Skin Care • Massage  
Nails • Hair & More

**\$5 off**  
One Hour Facial

Offer expires 08/31/23

**\$10 off**  
First  
Electrolysis Session

Offer expires 08/31/23

**NEW CUMBERLAND  
BOROUGH OFFICE**  
1120 Market St  
New Cumberland, PA 17070

PRSRT STD  
U.S. POSTAGE  
**PAID**  
HARRISBURG, PA  
PERMIT NO. 609



This Community Newsletter is produced for NEW CUMBERLAND BOROUGH by  
Hometown Press • 215.257.1500 • All rights reserved®

To Place An Ad Contact Denise At Hometown Press • 215-813-8361 • DeniseOfHTP@yahoo.com

### Familiar faces. New name.

Stop in and discover all that's new for you at  
First Commonwealth Bank.® You'll find many of the  
same friendly faces you know ready to welcome you.

Silver Spring Office  
717.591.1360

Camp Hill Office  
717.730.2816



**FIRST**  
Commonwealth Bank.  
Member FDIC  
fcbanking.com

*Time to be first.*

**SAVE \$ ... SAVE TIME ... SAVE GAS**

**FREE PICKUP & DELIVERY**



717-920-5500  
[classicdrycleaner.com](http://classicdrycleaner.com)



### PROFESSIONAL DESIGN & INSTALLATION

Custom Home Theater • Distributed Audio & Video  
Automation • Lighting Control • Window Candles •  
Weather Proof HDTV & Speakers •  
Central Vacuum Systems • Structured Wiring •  
Surveillance & Security Systems

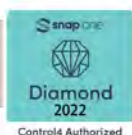

## Residential & Commercial



*We Stock the Areas Largest Selection of Premium Gas,  
Charcoal and Specialty Grills and Fire Tables*

PA008048

5248 East Trindle Road, Mechanicsburg, PA 17050 • 717-790-0454 • [www.todayshomeandleisure.com](http://www.todayshomeandleisure.com)